

- NOTES:
1. ALL MEASUREMENTS ARE IN METRES UNLESS OTHERWISE SPECIFIED.
 2. AREAS LABELED 'TBC' ARE TO BE DETAILED DURING THE NEXT DESIGN STAGE.
 3. ALL EARTHWORKS SHOWN ARE 1 IN 3 SLOPES UNLESS OTHERWISE STATED.
 4. PLEASE SEE DRAWING 10042920-ARC-HGN-ZZ-DR-HE-00008 FOR TYPICAL CROSS SECTIONS.
 5. DETAILS OF THE ACCESS CONNECTIONS TO EACH DEVELOPMENT PLOT ARE TO BE CONFIRMED AT DETAILED DESIGN STAGE.
 6. DETAILS OF THE DEVELOPMENT SITE CAN BE FOUND ON THE MAIN MASTER PLAN SUPPLIED BY AHR.

- KEY:
- SITE BOUNDARY
 - PROPOSED CARRIAGEWAY
 - SHARED USE ROUTE
 - PROPOSED FOOTWAY
 - PROPOSED VERGE
 - PROPOSED EARTHWORKS
 - PROPOSED FENCING
 - PROPOSED LIGHTING
 - ▲ PROPOSED LIGHTING WITH BEACON



Rev	Date	Description	Prod	Chk	Rev	App
P01	13/01/23	FIRST ISSUE	DM	PE	JP	GC

Bath & North East Somerset Council

Project: **Somer Valley Enterprise Zone**

Site	Client
Old Mills Lane Midsomer Norton	Bath & North East Somerset Council Lewis House Manvers Street BA1 1JG www.bathnes.gov.uk

ARCADIS

Registered office: 80 Fenchurch Street, London EC3M 4BY
 Coordinating office: 2 Glass Wharf, Temple Quay, Bristol BS2 0FR
 Tel: 44 (0)117 372 1200

www.arcadis.com © Copyright reserved

**GENERAL ARRANGEMENT
SHEET 3 OF 6**

Designed: P. Ellis	Signed: Digitally Signed	Date: 09/12/22
Produced: D. Montleone	Signed: Digitally Signed	Date: 12/01/23
Checked: P. Ellis	Signed: Digitally Signed	Date: 12/01/23
Reviewed: J. Phillips	Signed: Digitally Signed	Date: 12/01/23
Approved: G. Care	Signed: Digitally Signed	Date: 13/01/23
Design Stage: Preliminary Design		
Original Size: A1	Grid: OS	Datum: AOD
Suitability Code: S5	Scale: AS SHOWN	Project Number: 10042920
Suitability Description:		

Suitable for Review and Acceptance

Drawing Number: 10042920 - ARC - HGN - ZZ - DR - HE - 00004	Revision: P01
---	-------------------------

OLD MILLS LANE

ROYAL OAK FARM

This map is based on Ordnance Survey material with the permission of the Controller of Her Majesty's Stationary Office. Crown Copyright. Unauthorised reproduction infringes Crown Copyright and may lead to prosecution or civil proceedings. © Crown copyright and database rights 2020. BATH AND NORTH EAST SOMERSET COUNCIL. Licence No. 100023334.

SCALE 1:500 (A1)
SCALE 1:1000 (A3)

Print Date: 2023-01-13 11:52:02

C:\bms\arcadis-uk-09\dms47348\10042920-ARC-HGN-ZZ-DR-HE-00004.dwg

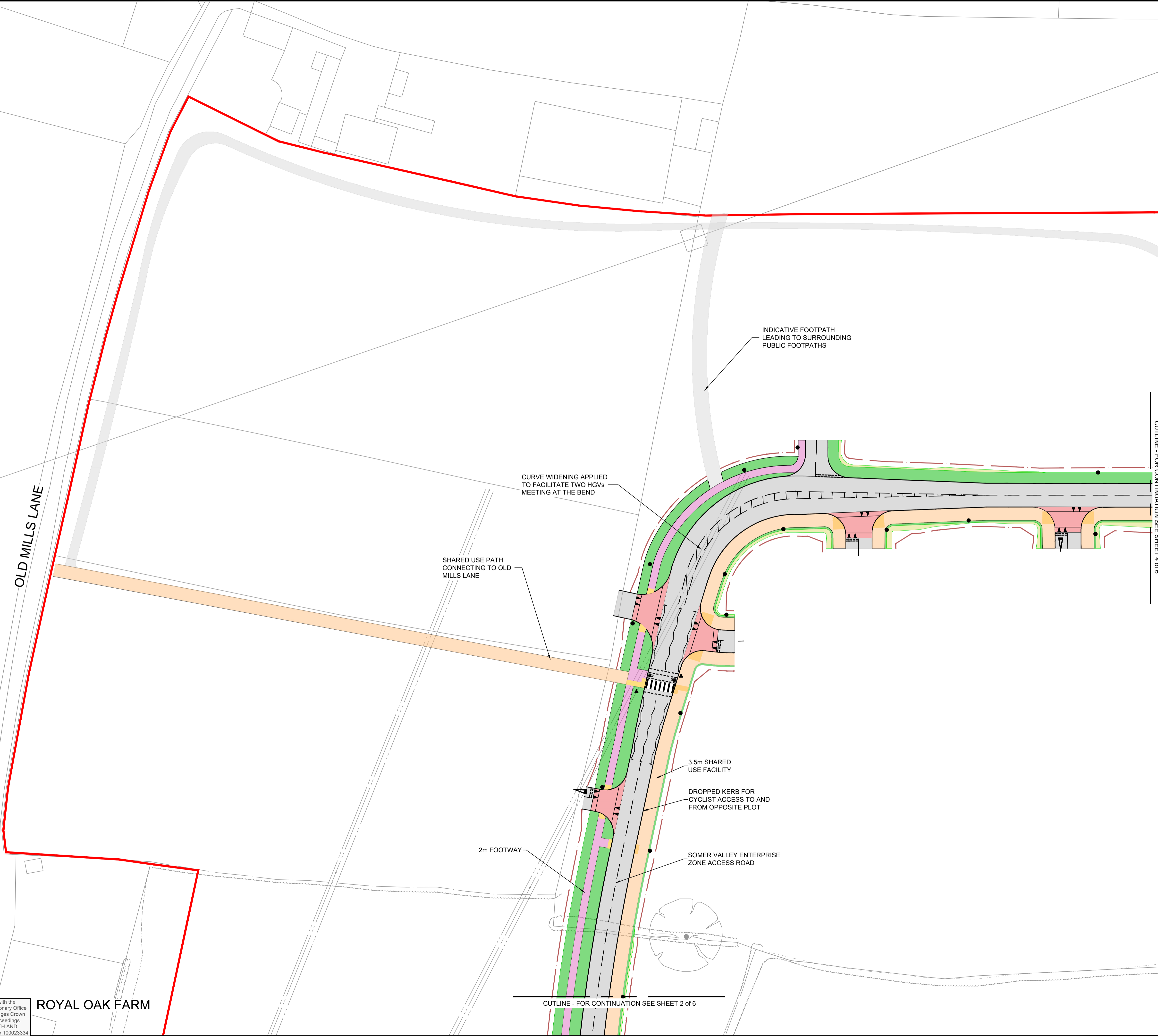

CUTLINE - FOR CONTINUATION SEE SHEET 2 OF 6

CUTLINE - FOR CONTINUATION SEE SHEET 4 OF 6